

RESOLUTION 2022-04

A RESOLUTION APPROVING THE PURCHASE OF OUTDOOR FITNESS EQUIPMENT FROM GREENFIELD OUTDOOR FITNESS

WHEREAS, the Village of Sherman prepared and solicited bids for the purchase of outdoor fitness equipment for Sherman Village Park Site Improvements projects under TIF funding allocations;

WHEREAS, the Village received and reviewed bids and wishes to proceed to purchase outdoor fitness equipment from Greenfields Outdoor Fitness;

THEREFORE, BE IT RESOLVED the Village of Sherman Board of Trustees authorizes the President to execute an agreement with Greenfields Outdoor Fitness in the amount of \$37,915 for the purchase of outdoor exercise equipment; (attached)

PASSED this 20th Day of September, 2022 at Sherman, Sangamon County, Illinois.

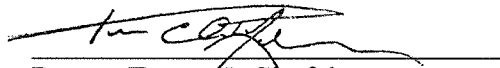

VILLAGE OF SHERMAN

 By: Trevor J. Clatfelter
 Its: Village President

Attest:

 Michael Stratton,
 Deputy Village Clerk

	YES	NO	ABSENT	PRESENT
BULL	✓			
GRAY	✓			
HAHN			✓	
LONG	✓			
ROCKFORD	✓			
SCHULTZ	✓			
CLATFELTER	✓			
TOTALS:	6	0	1	0



2617 West Woodland Drive, Anaheim, CA 92801 USA
 T: 888.315.9037 F: 866.308.9719 Info@Greenfieldsfitness.com

Customer Quotation

Date	Quote #
5/9/2022	Q019754

Sold To
Village of Sherman Michael Stratton 401 St. John Drive Sherman, IL 62684

Ship To
Sherman Village Park V2 1200 Rail Fence Dr Sherman, IL 68684

Project Name	Terms	Quote Valid Until	Rep
Sherman Village Park	50% Deposit, Balance	6/30/2022	GN

Item	Description	Color	Qt	Rate	Total
UBX215-01	Leg Press (adjustable resistance)	Green	1	5,995.00	5,995.00T
UBX217-01	Squat (adjustable resistance)	Green	1	5,995.00	5,995.00T
UBX221-01	Back Extension Pro	Green	1	2,495.00	2,495.00T
UBX223-01	Sit-Up Bench	Green	1	2,695.00	2,695.00T
UBX244-01	Triceps Press (adjustable resistance)	Green	1	5,995.00	5,995.00T
UBX246-01	Chest Press (adjustable resistance)	Green	1	5,995.00	5,995.00T
UBX247-01	Vertical Press (adjustable resistance)	Green	1	5,995.00	5,995.00T
	Subtotal				35,165.00
Shipping & H...	Ships in large crates - forklift is needed to unload			2,750.00	2,750.00T
SM Installation	All units are Surface Mount installation method, installation NOT included and done by others				
Terms for bid...	Terms for bidders: - 50% Deposit with a signed order - Balance due upon receipt - Without a payment bond, prepaid terms apply				

Additional Terms and Conditions of Sale

1. THIS QUOTE IS LIMITED TO AND GOVERNED BY THE TERMS CONTAINED HEREIN. Greenfields Outdoor Fitness, Inc. ("Greenfields") objects to any other terms proposed by Customer, in writing or otherwise, as material alterations, and all such proposed terms shall be void. Customer authorizes Greenfields to ship the Equipment and agrees to pay Greenfields the total amount specified. Shipping terms are FOB the place of shipment via common carrier designated by Greenfields. Payment terms are specified on Quote and all charges are due and payable in full to Greenfields Outdoor Fitness Inc, 2617 West Woodland Drive, Anaheim, CA 92801 unless notified otherwise by Greenfields in writing. Customer agrees to pay all additional service charges for past due invoices. Customer must provide proper tax exemption certificates to Greenfields, and shall promptly pay and discharge all otherwise applicable taxes, license fees, levies and other impositions on the Equipment at customers own expense. Purchase orders and payments should be made to the order of Greenfields Outdoor Fitness, Inc.

2. Use & Maintenance. Customer agrees to regularly inspect and maintain the Equipment as recommended by Greenfields.

3. Default, Remedies & Delinquency Charges. Customer's failure to pay any invoice when due, or its failure to otherwise comply with the terms of this Quote, shall constitute a default under all unsatisfied invoices ("Event of Default"). Upon an Event of Default, Greenfields shall have all remedies available to it at law or equity, including, without limitation, all remedies afforded a secured creditor under the uniform Commercial Code. Customer agrees to assist and cooperate with Greenfields to accomplish its filing and enforcement of mechanic's or other liens with respect to the Equipment or its location or its repossession of the Equipment, and Customer expressly waives all rights to possess the Equipment after an Event of Default. All remedies are cumulative and not alternative, and no exercise by Greenfields of a remedy will prohibit or waive the exercise of any other remedy. Customer shall pay all reasonable attorneys' fees plus any costs of collection incurred by Greenfields in enforcing its rights hereunder. Subject to any limitations under law, Customer shall pay to Greenfields as liquidated damages, and not as a penalty, an amount equal to 1.5% per month of any payment that is delinquent in such month and is not received by Greenfields within ten (10) days after the date on which due.

CUSTOMER APPROVAL I hereby approve this order, the item selection, color selection and overall Terms & Conditions of this order. Name: _____ Date: _____ Signature: _____ PLEASE SIGN & Email to: Orders@GreenfieldsFitness.com	Subtotal	\$37,915.00
	Sales Tax (0.0%)	\$0.00
	Total	\$37,915.00



VERTICAL PRESS (ADJUSTABLE RESISTANCE)



bidirectional resistance

UBX247

Equipped with **SafeStop**

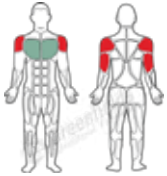

Strengthens:

- Chest
- Front shoulders
- Arms (triceps)

Target muscles

Secondary muscles

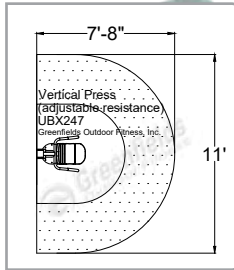

This unit accommodates wheelchair users who are able to transfer



VIEW THE VIDEO

<http://g/outdoorfitness.com/adjustable-vertical-press-video/>



CHEST PRESS (ADJUSTABLE RESISTANCE)



bidirectional resistance

UBX246

Equipped with

SafeStop



Target muscles
Secondary muscles

Strengthens:

- Chest
- Back
- Arms (triceps, forearms)
- Shoulders
- Abs

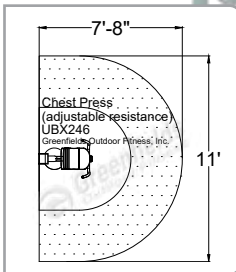

VIEW THE VIDEO

<http://gfoutdoorfitness.com/adjustable-chest-press-video/>



The Greenfields Advantage - this unit incorporates Safe-Stop technology for a workout that's smooth and hazard-free



TRICEP PRESS (ADJUSTABLE RESISTANCE)



bidirectional resistance

UBX244

Equipped with

SafeStop



Target muscles

Secondary muscles

Strengthens:

- Arms (biceps, triceps)
- Chest
- Shoulders

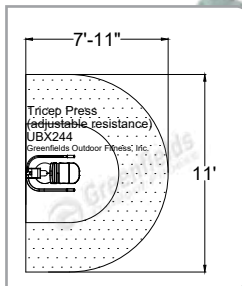

This unit accommodates wheelchair users who are able to transfer



VIEW THE VIDEO

<http://gfoutdoorfitness.com/adjustable-tricep-press-video/>





SIT-UP BENCH

UBX223

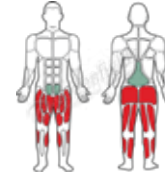
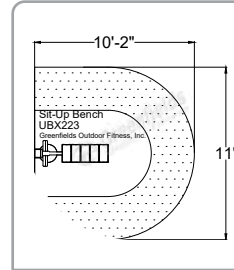

Target muscles
Secondary muscles

Strengthens:

- Abs

This unit accomodates wheelchair users who are able to transfer

VIEW THE
VIDEO



<http://gfoutdoorfitness.com/sit-up-bench-video/>



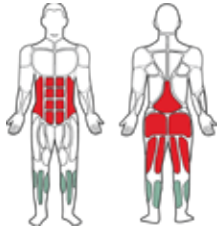

Strengthens hamstrings, glutes, lower back and core

Target muscles

Secondary muscles



VIEW THE VIDEO

<https://gfoutdoorfitness.com/back-extension-pro-video/>

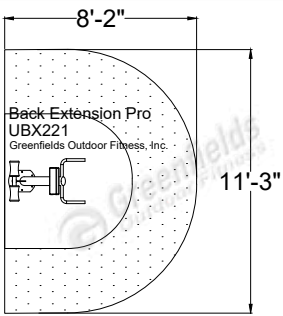

SQUAT (ADJUSTABLE RESISTANCE)



bidirectional resistance

UBX217

Equipped with

SafeStop

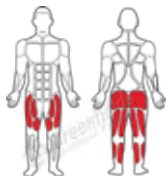

Strengthens:

- Glutes
- Legs

Target muscles

Secondary muscles

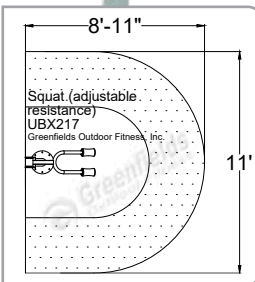

The Greenfields Advantage - this unit incorporates Safe-Stop technology for a workout that's smooth and hazard-free



VIEW THE VIDEO

<http://gfoutdoorfitness.com/adjustable-squat-video/>





LEG PRESS (ADJUSTABLE RESISTANCE)



bidirectional resistance

UBX215

Equipped with

SafeStop

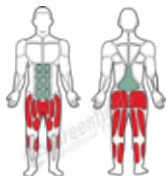

Strengthens:

- Abs
- Glutes
- Legs

Target muscles

Secondary muscles

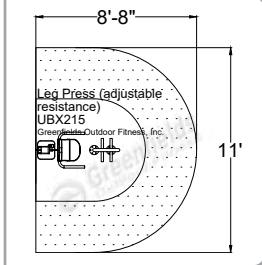

VIEW THE VIDEO

<http://gfoutdoorfitness.com/adjustable-leg-press-video/>



The Greenfields Advantage - this unit incorporates Safe-Stop technology for a workout that's smooth and hazard-free

